

ANNUAL CATHOLIC SCOUT RETREAT XXVI – 2017

September 29 - October 1, 2017

Leader's Guide

Blessed Justo Takayama Ukon
Theme: Unity
Mysteries of the Rosary - Sorrowful

Veterans Memorial Park
13000 Sayre St.
Sylmar, CA 91342



CATHOLIC COMMITTEE ON SCOUTING - ARCHDIOCESE OF LOS ANGELES

www.ccsala.org

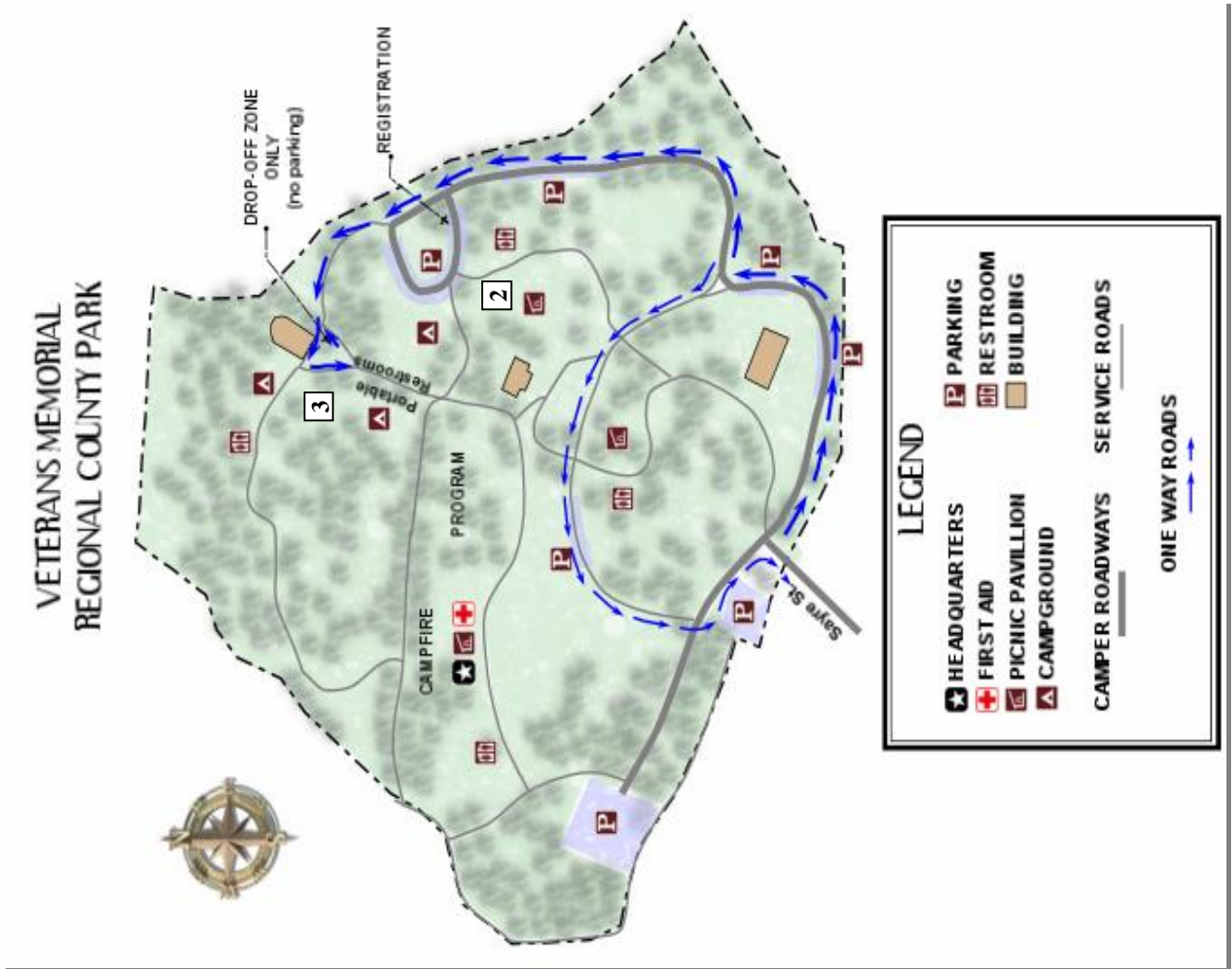

Please read this leader's guide carefully, as it contains important program information.

Overview of the program:

Our Scout Retreat is held at Veteran's Memorial Park in Sylmar. It is a County Park at the base of the foothills. Each unit brings their own camping gear, cooking gear, and food. The camping area is a grassy area with some trees. In addition to the permanent restrooms with flush toilets, we will have a large number of portable toilets.

As a Scouting event, each unit (Troop, Crew, Pack, or family) expected to adhere to Boy Scout guidelines (or Girl Scout, Campfire USA or American Heritage Girls guidelines.) At the Cub Scout level (grades 1-5), this means one adult per youth. Each unit is expected to complete registration for the retreat.

Friday, September 29, is an optional arrival and set-up day. If you wish to camp you may arrive on Friday, September 29th from 5:00 pm-8:00 pm. On Saturday, check in will begin at 7:00 am, we will gather at 8:45 a.m. as an entire group. All attendees will be divided into small groups during registration and check in. Youths will be paired with other youths of the same age, not from their own unit. Youths are expected to stay with their group for the entire day. All youths must be picked up by an adult from the designated area. An adult **MUST** accompany each youth (all day) in grades K-1. It is recommended that an adult accompany youth in grades 2-3, and optional for adults to accompany youth in grades 4-5. Any adults not with youth will be in the adult patrol.

Access (Camping/Saturday Parking)

All vehicles enter Veteran's Memorial Park from Sayre St. and proceed to registration (Follow signs). Then proceed to the drop off passengers and equipment zone (NO PARKING) and return quickly to the parking area. You will be directed to the camping areas. Cubs/Webelos, American Heritage Girls, Campfire USA, Girl Scouts, and family groups will use a different camping area from Boy Scout troops.

There is absolutely no driving on the concrete walkways or grass, even to unload! No cars (other than Retreat staff) are permitted on the road beyond the kybos at any time. Please cooperate with Retreat staff as they direct you where to camp, unload, and park. Please move your vehicle to the parking lot **BEFORE** setting up your campsite.

At the end of the Retreat, all vehicles may again load at the drop off zone (NO PARKING) noted on the map. **Have all your equipment ready to load before driving up.** Return to the Registration Area for **check-out by 11:00 Sunday. All groups should plan on leaving by 11am.** If you are only attending the retreat on Saturday, please park in the parking lot and proceed to the registration area.

REGISTRATION AND PERMISSION SLIP

Upon arrival, present your REGISTRATION sheet(s) showing names, Youths and Adults, and scouting status (School grade, Scouter or non-scout) of all members attending from your unit(s) and have available for inspection your MEDICAL RELEASES.

Each youth (Scout or non-Scout) must have a permission slip. A copy of the Parent's Permission Slip is enclosed. You need one sheet for each youth (under 18 years of age) in your unit to be completely filled out and signed by the minor's parent or guardian. There are two copies on a page. One will be turned in at registration and will be given to the small group facilitator. The other copy must be kept in the unit leader's possession at all times while en route to, present at and returning from the Retreat. For additional copies, you may reproduce the one enclosed.

PROGRAM NOTES

Retreat registration includes neckerchief, patch, lunch and snack on Saturday only. All other meals are on your own. We intentionally try not to group Scouts from the same unit together. **Scout uniforms are required.** Jackets, of course, are optional according to the weather.

All youths are expected to participate in the full day of program activities. No one, including adults, is to be in the campsite areas during the program time. All adults, senior patrol leaders and all staff members are

expected to attend the scheduled functions. Scout leaders, this is not a preparation for Camporee or other activities. **Scouts are to remain in their retreat saint patrols until dinner.**

There will be a leader meeting at 8 a.m. on Saturday morning at the headquarters pavilion. It is very important that a representative from all units attend. We will be reviewing some of the changes in procedures from previous years. All adult leaders, senior patrol leaders and all lead staff members are expected to attend.

All small groups will cover the information necessary for the Rosary patch. Participants who successfully complete the requirements will be given a signed note that they have completed the requirements. The unit leader should collect these along with the money for the Rosary patches and submit one order form for the unit at the time of checkout. **Patches will only be sold on the unit level with the order form and the notes indicating the requirements were completed.**

MISCELLANEOUS

If a parent needs to pick up a Scout during the program, they are to report to the headquarters pavilion. The unit leader will be located, and the unit leader along with retreat staff will locate the Scout. They will bring the Scout back to the Headquarters pavilion for release to the parent.

There will be no smoking allowed. No alcoholic beverages or non-prescribed controlled drugs will be permitted. No radios, tablets, Ipads, IPods, etc., or unauthorized phone use.

Each person should bring a water bottle and drink plenty of water.

All youth (under 18) **must use the kybos (portable toilets) only.** Youth will not be allowed to use permanent bathrooms at the park. This is to ensure compliance with BSA Youth Protection policies regarding bathrooms.

“Lost and Found” location is at headquarters.

Each unit camping will be responsible for policing its own area as well as helping to clean the entire Retreat area. You **MUST** provide your own garbage bags to collect whatever garbage and rubbish you generate and take it home with you. We are **NOT** allowed to use the park’s trash containers. If they are used, we (you) may be charged.

All units camping at night are expected to participate/perform in the campfire on Saturday evening please be prepared. Groups must see the Campfire leader during the day on Saturday to have their skit or song approved and put on the schedule.

No fires whatsoever will be allowed during the Scout Retreat. This includes barbecues, hibachis, candles, etc. No charcoal or wood fires will be allowed. We will not have a fire at our campfire program. Cooking must be done with propane stove only! Please plan your meals accordingly.

Report all injuries to the First Aid area.

If you or your child(ren) need reasonable accommodation at this Retreat, please contact the Retreat chair at 818-298-0048/Email: diana.campos@ccsala.org as soon as possible or at a minimum 2 weeks before the Retreat. This includes but is not limited to gluten free hosts.

ADDITIONAL ITEMS AVAILABLE. The following patches will be available for purchase:

Duty to God National Catholic Committee on Scouting	\$1.00
NCCS Rosary Patch	\$4.00
Additional Retreat XXIII Patches (if available)	\$3.00
Vintage Retreat Patches will be available.....	\$3.00

Please check the CCSALA website (www.ccsala.org) prior to leaving for the Retreat for any last-minute changes caused by weather or other conditions.

CATHOLIC COMMITTEE ON SCOUTING - ARCHDIOCESE OF LOS ANGELES

CATHOLIC SCOUT RETREAT - UNIT REGISTRATION FORM

Page _____ of _____

- Pack
- Troop
- Crew

Select one _____ Council _____ Year _____
 Unit Number _____ Spell out please _____

PARTICIPANT'S NAME	SCOUT YOUTH (indicate school grade in box)	ADULT (check box if non-scouter)
1	<input style="width: 30px; height: 20px;" type="text"/>	<input type="checkbox"/>
2	<input style="width: 30px; height: 20px;" type="text"/>	<input type="checkbox"/>
3	<input style="width: 30px; height: 20px;" type="text"/>	<input type="checkbox"/>
4	<input style="width: 30px; height: 20px;" type="text"/>	<input type="checkbox"/>
5	<input style="width: 30px; height: 20px;" type="text"/>	<input type="checkbox"/>
6	<input style="width: 30px; height: 20px;" type="text"/>	<input type="checkbox"/>
7	<input style="width: 30px; height: 20px;" type="text"/>	<input type="checkbox"/>
8	<input style="width: 30px; height: 20px;" type="text"/>	<input type="checkbox"/>

A. Total number of early-registered participants _____ x \$20.00 = \$ _____
 (adults and children – all adults attending must be registered and pay even if they are not staying the night)
 (Paid & pre-registered postmarked no later than **09/15/17**)

B. Total number of **after-deadline** registered participants _____ x \$25.00 = \$ _____

Total _____ \$ _____

Make checks payable to: Catholic Committee on Scouting

Mail completed form to: Mary Ann Moore, Treasurer
 (postmarked by **09/15/17**) 277 Sunset Drive
 Channel Islands, CA 93035-4479

NOTE: If more than one page is needed, sign all pages, but carry total to final page. **All checks must have a phone number.**

I certify that I have in my immediate possession a "Parent's Permission Slip" and Medical Release Form for each minor named above. I and all adults named above hereby release The Catholic Committee on Scouting, the Catholic Archdiocese of Los Angeles, its officers, leaders, agents or members, Boy Scouts of America, Girl Scouts of America, American Heritage Girls, and all municipal agencies whose property and / or personnel are used from responsibility for any injuries or damages we may suffer as a result of our participation in or transportation to/from the Retreat.

Unit Leader _____ Position _____ Date _____

Print

Address _____ City _____ State _____ ZIP _____

Phone _____ Unit leader
 Signature _____

[Revision: June 2017]

CATHOLIC COMMITTEE ON SCOUTING - ARCHDIOCESE OF LOS ANGELES

www.ccsala.org

Parent's Permission Slip - Required for Youth

To be submitted to Unit Leader, and given to small group facilitator

I request that my child _____ **Grade** _____
be permitted to attend the Catholic Committee on Scouting, Archdiocese of Los Angeles (CCSALA) Retreat for
Cubs/Webelos/Scouts/Explorers. He/she is in good physical condition. Should any illness or accident occur to him/her on
the trip, I will not hold the Boy Scouts of America, Girl Scouts of the USA, the American Heritage Girls, Campfire USA the
Catholic Committee on Scouting, Archdiocese of Los Angeles, its officers, leaders, agents or members liable for medical
or other expenses incurred in the care of my son/daughter.

I understand that photographs and videos taken at this event may be published on the CCSALA web site
(www.ccsala.org) and used in future promotional event materials, and hereby grant permission for this use of any photo
that may include the image of my child.

If my child is in the 8th-12th grade, I give permission for him/her to participate in a climbing wall/obstacle course activity.

My child may receive medical attention by a licensed physician. He/she may be admitted to a hospital in case of
emergency (Parents will be contacted immediately, if possible).

Doctor's Name _____ Medication my son is currently taking: _____
Dr. Address _____
Dr. Phone _____
Parent's Phone _____ Emergency Phone _____
Date _____ Parent/Guardian Signature _____

I request that my child _____ **Grade** _____
be permitted to attend the Catholic Committee on Scouting, Archdiocese of Los Angeles (CCSALA) Retreat for
Cubs/Webelos/Scouts/Explorers. He/she is in good physical condition. Should any illness or accident occur to him/her on
the trip, I will not hold the Boy Scouts of America, Girl Scouts of the USA, the American Heritage Girls, Campfire USA, the
Catholic Committee on Scouting, Archdiocese of Los Angeles, its officers, leaders, agents or members liable for medical
or other expenses incurred in the care of my son/daughter.

I understand that photographs and videos taken at this event may be published on the CCSALA web site
(www.ccsala.org) and used in future promotional event materials, and hereby grant permission for this use of any photo
that may include the image of my child.

If my child is in the 8th-12th grade, I give permission for him/her to participate in a climbing wall/obstacle course activity.

My child may receive medical attention by a licensed physician. He/she may be admitted to a hospital in case of
emergency (Parents will be contacted immediately, if possible).

Doctor's Name _____ Medication my child is currently taking: _____
Dr. Address _____
Dr. Phone _____
Parent's Phone _____ Emergency Phone _____
Date _____ Parent/Guardian Signature _____